

DOGS POLICY SOWERBY SPORTS VILLAGE

Sowerby Sports Village was created for the health and wellbeing of all. We know that lots of people love dogs and that they are vital to the mental and physical wellbeing of many. However, now that formal sport is due to start on site and for the safety of all users, some changes need to be made. Much of the grant funding, especially for the formal sports pitch areas, requires that dogs are not allowed in these areas for the health and safety of those taking part in the sporting activity. Many other parks and sport pitch areas in the UK either prohibit dogs entirely or require them to be kept on a lead at all times. We have tried to strike a sensible and safe balance with our Dogs at Sowerby Sports Village policy.

Where can I walk my dog?

The site has been split into zones to provide a balance between dog walking activity and user safety.:

- **GREEN** – dogs can freely use these areas, off a lead. **GREEN OFF LEAD**
- **AMBER** – dogs can walk these areas but must be kept on a lead **AMBER ON LEAD**
- **RED** – dogs are not allowed within these areas **RED NO DOGS**

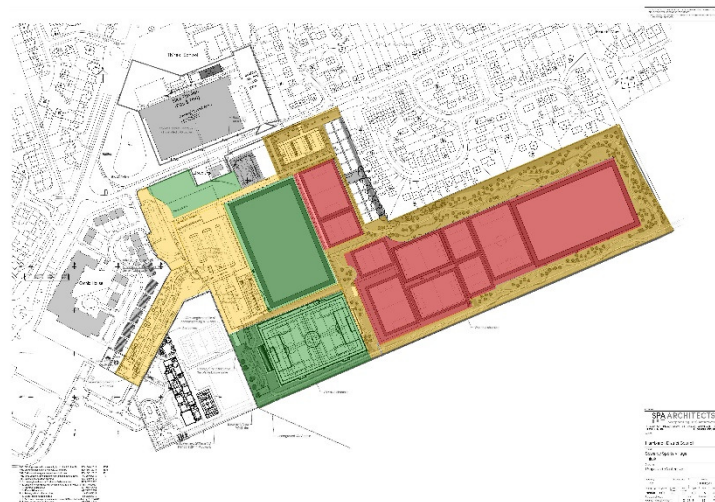

Signs to inform users of these changes will be installed and there will be occasional dog warden visits to the site but clearly the success of the policy will depend upon the behaviour and mutual respect of our users.

Dog Fouling

‘Your dog, your mess’– dog walkers must clear up any faeces from their dog in all areas of the site. Dog poo can contain parasites capable of leading to dangerous, life-threatening infections. User must use the bins located around the site and not be offended if another visitor asks them to clear up after their dog as this is their responsibility.